

8-foot table
SET UP

8-foot table
SET UP

OUTSIDE REAR PATIO

REAR ENTRANCE

MR FERTILIZER

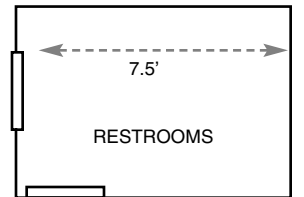

KITCHEN IN REAR

3.5'

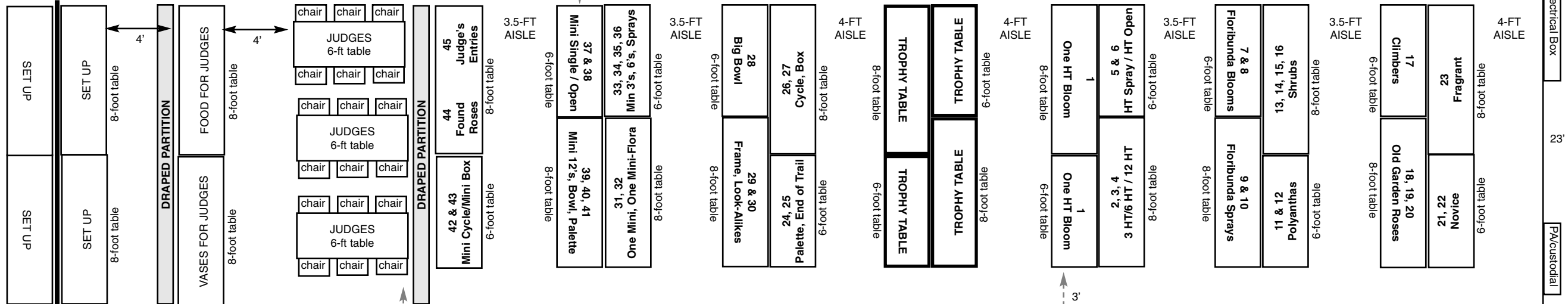

RESTROOM IN REAR

5.5'

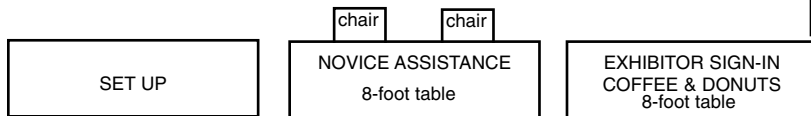

NOTE: Use calligraphy & recording tables for membership inside foyer after judging is finished.



FOYER ENTRANCE

13.5'

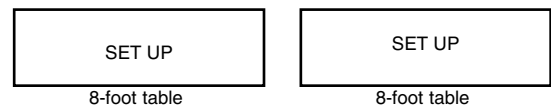
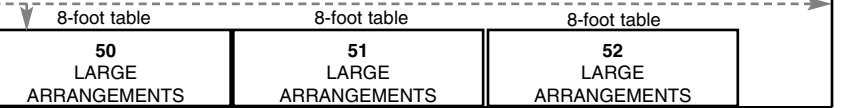

WILLIAM S. HART
COWBOY MUSEUM

KB REV 9/7/09

HERITAGE JUNCTION
TRAIN STATION, OLD HOMESTEAD,
AND ANTIQUE ROSE GARDEN

HART EQUIPMENT NEEDED:
 11 6-ft rectangle tables
 30 8-ft (60") rectangle tables
 4 5-ft round tables
 52 white chairs
**SET UP ON FRIDAY 11/6/09
 COMPLETED BY NOON**

Santa Clarita Valley Rose Society: ROSE SHOW

Hart Hall -- William S. Hart Park, Newhall

Floor Plan for Saturday, November 7, 2009

Exhibitors set up in parking lot.

**All properties are in the trailer & water is in the barrel in the parking lot.
 Judges meet for breakfast and lunch at the left rear of the showroom.**

RENTALS NEEDED:
 3 umbrellas & stands
 2 16-ft dividers & drapes
 5 6-ft rectangle tables
 30 8-ft white linens
 16 6-ft white linen
 1 5-ft round white linen